

PROFESSIONAL WALK-BEHIND MOWERS

THE CHOICE OF PROFESSIONALS



JOHN DEERE

NOTHING RUNS LIKE A DEERE

OUTSTANDING FEATURES

PROFESSIONAL WALK-BEHIND-MOWERS

When your business depends on your mowers, it pays to invest in John Deere products. With their legendary build quality and practical features, plus outstanding service, John Deere mowers deliver excellent cut quality and productivity year on year. Why compromise?



POWERFUL ENGINE

The modern OHV engine has a 25 mm forged crankshaft (PRO 47V, JX90C, C52KS), ball-race main bearings and cast cylinder sleeves for long years of service. AutoChoke enables easier starting on cold mornings and the steady torque curve lets you work on inclines of up to 58% when conditions allow.



LOW VIBRATION

Work longer and safer with reduced vibration exposure to the operator thanks to the robust AntiVibrationSystem. You don't need to interrupt your working day.

TOUGH GUY

The aluminium chassis has additional steel plate reinforcement on both the inside and outside for durability, meaning you don't have to worry about stones, dents, knocks and corrosion.





TURBOSTAR SYSTEM

Whatever the weather, the proven TurboStar System ensures a precision cut and great collection every time. Even in damp conditions, the air flow generated by the blade draws the grass up straight before cutting; it also removes leaves from your lawn. After cutting, the air vacuum blows the clippings into the collection bag smoothly and efficiently. The TurboStar Signal makes things even easier by alerting you in good time when the bag is almost full. (PRO 47V, JX90C, JX90CB)



Optimum bag fill: Thanks to the TurboStar System the collection bag gets filled up to 100%.

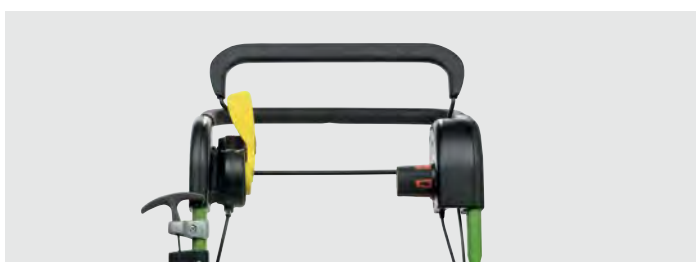

Smart move: The Blade Brake Clutch (BBC) stops the blade but not the engine. That makes it much easier to move your machine from A to B and saves time whenever you empty the collection bag. (JX90CB)

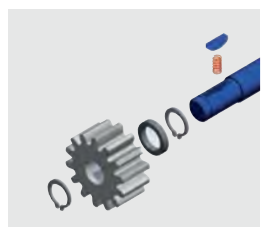

© Bi.Ci.Di. Srl

Robust metal wheels: The high quality metal wheels with rubber tyres ensure maximum grip and durability; reinforced flanks protect the wheels when you're mowing edges.

Tough transmission: The rugged gearbox lets you use the engine's high torque to the full in any setting. It has tough bronze / steel gears, a smooth, dual wrap spring clutch – and a diecast aluminium housing that stays cool when you're working hard.



NON-STOP MOWING

Up to eight hours without refuelling: the large 6 litre tank enables you to work for longer between stops. (JX90C, JX90CB, C52KS)



NO TOOLS REQUIRED

The handlebar folds down quickly for easy storage and transportation. (PRO 47V, JX90C, JX90CB, C52KS, PRO 53MV)



OPTIONAL

Mulching kit: For even more flexibility, all John Deere professional mowers can be converted into mulching mowers with an optional mulching kit.



OPTIONAL

Protection: A front bumper protects the mower deck (PRO 47V, JX90C, JX90CB). The optional engine guard (C52KS) is ideal when lifting or securing your mower or for protection when mowing under and around shrubs.

PROFESSIONAL WALK-BEHIND-MOWERS



C43

1,500 m ²	
43 cm Working Width	
Briggs & Stratton	

- ReadyStart with automatic choke
- AntiVibrationSystem
- Engine, Nominal Power: 2.4 kW / 2,800 rpm
- Collection Capacity: 65 ltr
- Mulching Kit: Optional



PRO 47V

2,500 m ²	
47 cm Working Width	
Yamaha	
Variable-Speed: 2.7 – 4.5 km/h	
Light weight: 47.5 kg	

- Foldable Handlebar
- TurboStar System
- AntiVibrationSystem
- Engine, Nominal Power: 3.2 kW / 2,800 rpm
- Collection Capacity: 65 ltr
- Mulching Kit: Optional



JX90C

4,000 m ²	
54 cm Working Width	
Yamaha	
Variable-Speed: 2.7 – 4.8 km / h	

- Foldable Handlebar
- TurboStar System
- AntiVibrationSystem
- Engine, Nominal Power: 3.2 kW / 2,800 rpm
- Large Fuel Tank: 6 ltr
- Collection Capacity: 75 ltr
- Mulching Kit: Optional



JX90CB

4,000 m ²	
54 cm Working Width	
Yamaha	
Variable-Speed: 2.7 – 4.8 km / h	
Blade Brake Clutch	

- Foldable Handlebar
- TurboStar System
- AntiVibrationSystem
- Engine, Nominal Power: 3.2 kW / 2,800 rpm
- Large Fuel Tank: 6 ltr
- Collection Capacity: 75 ltr
- Mulching Kit: Optional



C52KS

5,000 m ²	
50 cm Working Width	
Subaru	
Variable-Speed: 2.9 – 4.8 km / h	

- Foldable Handlebar
- AntiVibrationSystem
- Nominal Power: 3.2 kW / 2,800 rpm
- Large Fuel Tank: 6 ltr
- Mulching Kit: Optional

PROFESSIONAL MULCHING MOWER



DIFFERENT CONDITIONS

Easily adapt to your mowing conditions by adjusting the driving speed. Maximum efficiency, minimum effort.



RESILIENT

The durable PRO 53MV has full crankshaft protection. It can absorb the impacts and keep on working.



COMFORTABLE HANDLING

Mow close to trees, bushes and other obstacles without scratching your hands, guiding the mower with just one hand.



PRO 53MV

5,000 m ²
53 cm Working Width
Briggs & Stratton
Variable-Speed: 2.6 – 4.1 km/h

- Foldable Handlebar
- AntiVibrationSystem
- Engine, Nominal Power: 3.2kW / 2,800 rpm

WARRANTY

3

YEARS*

The steel mower deck on our PRO 53MV mulching mower is so strong, we offer a 3-year warranty.

* Terms and conditions apply. See your John Deere dealer for details.



CUTTING ANGLE ADJUSTMENT

The height can be adjusted independently per axle for a more aggressive cut in tall grass.



C43 PRO 47V JX90C JX90CB C52KS PRO 53MV

PROFESSIONAL WALK-BEHIND-MOWERS

	C43	PRO 47V	JX90C	JX90CB	C52KS	PRO 53MV
RECOMMENDED MOWING AREA, m²	Up to 1,500	Up to 2,500	Up to 4,000	Up to 4,000	Up to 5,000	Up to 5,000
WORKING WIDTH, cm	43	47	54	54	50	53
COLLECTION	Standard	Standard	Standard	Standard	N/A	N/A
CAPACITY, ltr	65	65	75	75	N/A	N/A
TURBOSTAR SYSTEM	No	Yes	Yes	Yes	No	No
MULCHING	Optional	Optional	Optional	Optional	Optional	Standard
ENGINE						
Manufacturer	Briggs & Stratton with ReadyStart	Yamaha	Yamaha	Yamaha	Subaru	Briggs & Stratton with ReadyStart
Type	Petrol	Petrol	Petrol	Petrol	Petrol	Petrol
Nominal Power, kW (min ⁻¹)	2.4 at 2,800 rpm	3.2 at 2,800 rpm	3.2 at 2,800 rpm	3.2 at 2,800 rpm	3.2 at 2,800 rpm	3.2 at 2,800 rpm
Displacement, cm ³	190	190	190	190	190	190
DRIVE						
System	Push	Variable Speed	Variable Speed	Variable Speed	Variable Speed	Variable Speed
Max Speed, km/h	N/A	2.7 – 4.5	2.7 – 4.8	2.7 – 4.8	2.9 – 4.8	2.6 – 4.1
DECK HEIGHT ADJUSTMENT						
Cutting Height, mm	20 – 80	25 – 80	15 – 95	15 – 95	25 – 80	30 – 95
Adjustment	Central	4 point	4 point	4 point	4 point	2 point
Positions	9	7	8	8	7	7
START/STOP TYPE	Recoil	Recoil	Recoil	Recoil	Recoil	Recoil
HANDLEBAR						
Adjustable	Yes	Yes	Yes	Yes	Yes	Yes
Foldable	Yes	Yes	Yes	Yes	Yes	Yes
Hand Arm Vibration at the handle a [m/s ²] measured in accordance with EN ISO 5395 Measurement Uncertainty in accordance with EN 12096	2.5 / 1.3	2.5 / 1.3	2.5 / 1.3	2.5 / 1.3	2.5 / 1.3	2.5 / 1.3
DECK MATERIAL	Aluminium with Steel Insert	Aluminium with Steel Insert	Aluminium with Steel Insert	Aluminium with Steel Insert	Aluminium with Steel Insert	Steel
PROTECTION FRAME	No	No	No	No	Optional	No
WHEELS						
Diameter front/rear, mm	180 / 180	210 / 210	210 / 210	210 / 210	210 / 210	210 / 210
Bearings, front	Ball	Ball	Ball	Ball	Ball	Ball
Bearings, rear	Ball	bronzebushing	bronzebushing	bronzebushing	bronzebushing	bronzebushing
WEIGHT, kg	36.0	47.5	58	62	52	49
GUARANTEED SOUND POWER L [dB(A)] measured in accordance with 2000/14/EC	96	96	98	98	95	96
EMISSIONS-SOUND PRESSURE LEVEL AT OPERATORS STATION L [dB(A)] measured in accordance with EN ISO5395 /measurement Uncertainty in accordance with EN 12096	84 / 3	84 / 3	84 / 3	84 / 3	83 / 3	83 / 3



SCARIFIER

The D45C Scarifier is designed for operators who require high levels of performance across larger areas of operation. The 19 steel blades, which provide a 45 cm (17.7 in) working width, aggressively removes unwanted material allowing your lawn to breathe and promote grass growth. The compact and well balanced design means that the D45C can be easily manoeuvred, particularly beneficial when operating in confined areas.



D45C

4,000 m ²	
45 cm Working Width	
Petrol OHV Engine	

- Engine, Normal Power: 3.7 kW / 3,300 rpm
- Blade System: 19 Robust Steel Blades with Ball Bearings for Smooth Operation
- Stepless Adjuster for Working Depth
- Deck Material: Aluminium

D45C	
SCARIFIER	
RECOMMENDED MOWING AREA, m²	Up to 4,000
WORKING WIDTH, cm	45
COLLECTION	N/A
ENGINE	
Manufacturer	Briggs & Stratton
Type	Petrol, OHV
Nominal Power, kW (min ⁻¹)	3.7 at 3,300 rpm
Displacement, cm ³	208
DRIVE	
System	Push
Max Speed, km/h	N/A
DECK HEIGHT ADJUSTMENT	
Adjustment	Central
Positions	Stepless
START/STOP TYPE	Recoil
HANDLEBAR	
Adjustable	No
Foldable	Yes
Hand Arm Vibration at the handle [m/s ²] measured in accordance with EN 836/A4 / Measurement Uncertainty in accordance with EN 12096	8.6 / 4.3
DECK MATERIAL	Aluminium
WHEELS	
Diameter front / rear, mm	210 / 210
Bearings	Ball
WEIGHT, kg	44.0
GUARANTEED SOUND POWER L [dB(A)] measured in accordance with 2000/14/EC	98
EMISSIONS-SOUND PRESSURE LEVEL AT OPERATORS STATION L [dB(A)] measured in accordance with EN 836/A4 / Measurement Uncertainty in accordance with ISO 4871	81 / 3

This literature has been compiled for worldwide circulation. While general information, pictures and descriptions are provided, some illustrations and text may include finance, credit, insurance, product options and accessories not available in all regions. Please contact your local dealer for details. John Deere reserves the right to change specification and design of products described in this literature without notice. The green and yellow colour scheme, the leaping deer logo and the JOHN DEERE word mark are trademarks of Deere & Company.